



# INSTRUCTION BULLETIN

No. 340472  
Machine: ATLV 4300  
Published: 4-01/00  
System: ENGINE

**NOTE: DO NOT DISCARD the Parts List from the Instruction Bulletin. Place the Parts List in the appropriate place in your machine manual for future reference. Retaining the Parts List will make it easier to reorder individual parts and will save you the cost of ordering an entire kit.**

*NOTE: Numbers in parenthesis ( ) are reference numbers for parts listed in Bill of Materials.*

Installation instructions for kit number 374125

## **SYNOPSIS / PROBLEM:**

This kit contains the parts needed to install an engine air intake cover on the model ATLV 4300 litter vacuum.

Please follow step-by-step instructions.

## **SPECIAL TOOLS / CONSIDERATIONS: Hand drill, 3/32 drill bit**

(Estimated time to complete: 1/2 hour)

## **PREPARATION:**

(Refer to FIG. 1)

**FOR SAFETY: Before leaving or servicing machine, stop on level surface and set parking brake. Then turn off machine and remove key.**

## **INSTALLATION:**

(Refer to FIG. 1)

1. Locate the engine air intake opening on the left hand side of the machine. (Refer to FIG. 1)
2. Center the engine air intake cover over the engine air intake opening. (Refer to FIG. 1)
3. Using the engine air intake cover (1) as a template, mark and drill four 3/32 intake cover mounting holes.
4. Mount the engine air intake cover (1) over the air intake opening with four pan screws (2). (Refer to FIG. 1)
5. Check the engine air intake cover (1) for debris daily.

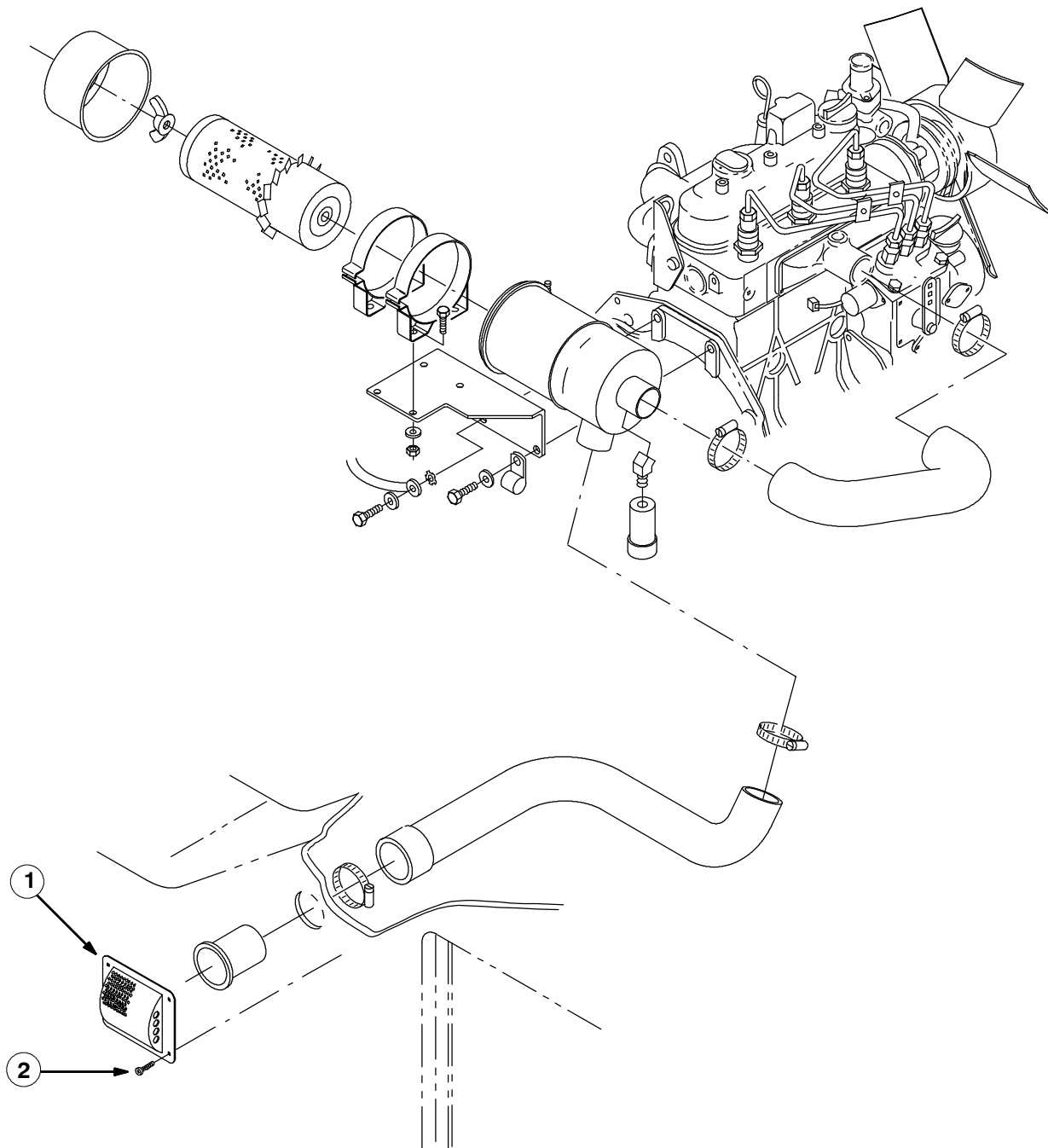

**FIG. 1 - ENGINE AIR INTAKE COVER INSTALLATION**

**BILL OF MATERIALS FOR ENGINE AIR INTAKE COVER KIT 374125**

Ref.	TENNANT Part No.	Description	Qty.
1	374766	Cover, engine air intake	1
2	360973	Screw, pan, #12-16 X 0.50, F/plstc	4

TENNANT COMPANY  
P. O. Box 1452  
Minneapolis, MN 55440-1452